

TENANT LIST

874	----	TOTAL FOOD & PHARMACY	-----	6,632 SF
878	----	JEANETTE SELLERS	-----	2,375 SF
888	----	GOODWILL	-----	14,095 SF
906	----	DOLLAR TREE	-----	13,849 SF

EXCEPT WITH RESPECT TO THE OBLIGATIONS OF LANDLORD WHICH ARE EXPRESSLY PROVIDED IN THE LEASE, LANDLORD HAS MADE NO AGREEMENT, REPRESENTATION OR WARRANTY WITH RESPECT TO THE STATUS OR EXISTENCE OF ANY LEASE, OCCUPANCY OR USAGE OF ANY SPACE, OR THE EXISTENCE, DESIGN OR LOCATION OF ANY BUILDINGS, IMPROVEMENTS, PARKING AREAS, CURB CUTS, DRIVES OR OTHER COMMON AREAS WITH RESPECT TO THE SHOPPING CENTER OR ANY OUTPARCELS OR OTHER PROPERTY. LANDLORD BELIEVES THAT THE INFORMATION CONTAINED WITHIN THIS DRAWING IS PRESENTLY CORRECT, BUT LANDLORD MAKES NO WARRANTY, REPRESENTATION OR GUARANTEE AS TO ITS ACCURACY OR WHETHER IT WILL REMAIN AS CONFIGURED, AND LANDLORD RECOMMENDS THAT ALL INFORMATION BE FIELD VERIFIED PRIOR TO DESIGN AND CONSTRUCTION.

36,951 SF TOTAL
174 PARKING SPACES
PARKING RATIO: 4.71 SP/1,000 SF

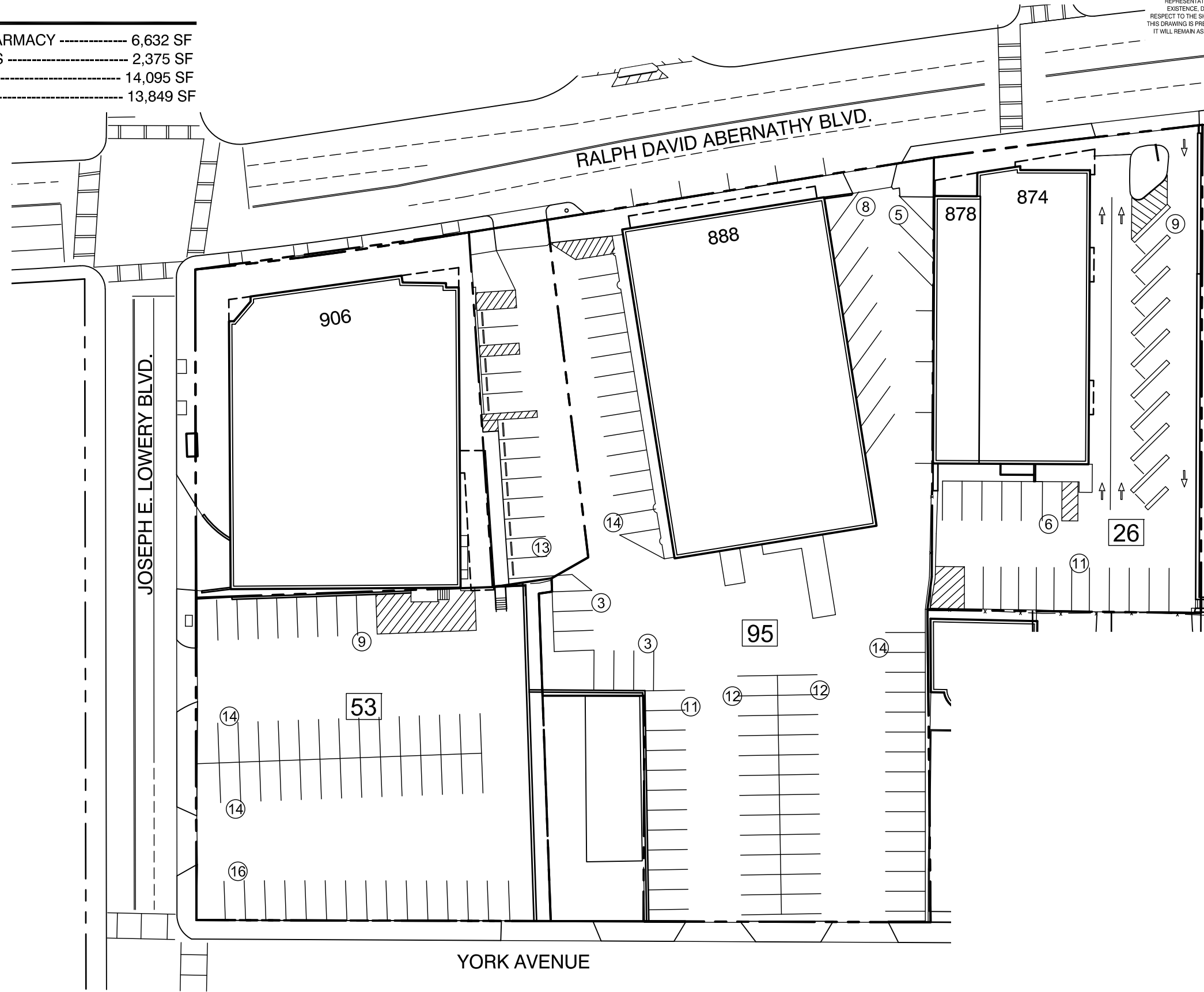

RALPH DAVID ABERNATHY BLVD: LEASING PLAN

874-906 RALPH DAVID ABERNATHY BLVD.
 893 YORK AVE.
 ATLANTA, GA. 30310

DRAWN BY: CO/KA DATE: 10/05/17

 1100 SPRING STREET NW SUITE 550
 ATLANTA, GEORGIA 30309-2848
 TEL (404) 876-5511 FAX (404) 875-2629

USER: conrail - Oct 05, 2017 - 11:55am
 S:\CONSTRUCTION\A\A\A\Cad\Ae_Build\Drawings\Retail\Ralph David Abernathy\Site Plan\RALPH DAVID ABERNATHY 874-906_LEASING.dwg