

EXCEPT WITH RESPECT TO THE OBLIGATIONS OF LANDLORD WHICH ARE EXPRESSLY PROVIDED IN THE LEASE, LANDLORD HAS MADE NO AGREEMENT, REPRESENTATION OR WARRANTY WITH RESPECT TO THE STATUS OR EXISTENCE OF ANY LEASE, OCCUPANCY OR USAGE OF ANY SPACE, OR THE EXISTENCE, DESIGN OR LOCATION OF ANY BUILDINGS, IMPROVEMENTS, PARKING AREAS, CURB CUTS, DRIVES OR OTHER COMMON AREAS WITH RESPECT TO THE SHOPPING CENTER OR ANY OUTPARCELS OR OTHER PROPERTY. LANDLORD BELIEVES THAT THE INFORMATION CONTAINED WITHIN THIS DRAWING IS PRESENTLY CORRECT, BUT LANDLORD MAKES NO WARRANTY, REPRESENTATION OR GUARANTEE AS TO ITS ACCURACY OR WHETHER IT WILL REMAIN AS CONFIGURED, AND LANDLORD RECOMMENDS THAT ALL INFORMATION BE FIELD VERIFIED PRIOR TO DESIGN AND CONSTRUCTION.

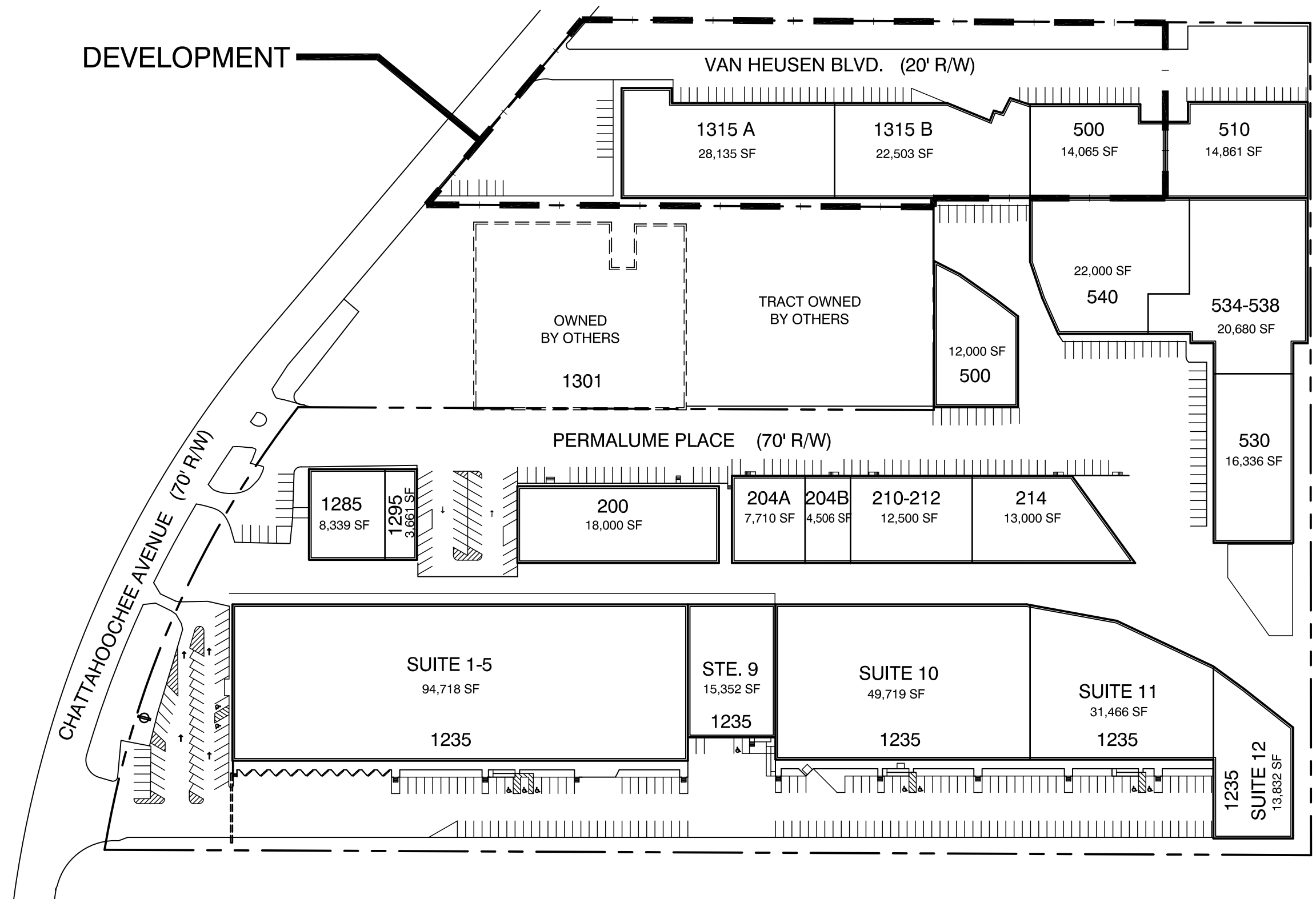

DEVELOPMENT

VAN HEUSEN BLVD. (20' R/W)

CHATTAHOOCHEE AVENUE (70' R/W)

PERMALUME PLACE (70' R/W)

1315 CHATTAHOOCHEE & 500 VAN HEUSEN BOULEVARD: LEASING PLAN



SCALE: 1" = 120'



NORTH

1315 CHATTAHOOCHEE AVE
& 500 VAN HEUSEN BLVD.
ATLANTA, GA. 30318

DRAWN BY: CO

DATE: 04/02/13



1100 SPRING STREET NW SUITE 550
ATLANTA, GEORGIA 30309-2848
TEL (404) 876-5511 FAX (404) 875-2629

USER: conall - Apr 02, 2013 - 9:57am
S:\CONSTRUCTION\AutoCAD\As_Built Drawings\Industrial\Permalume\Site Plan\PERMALUME_LEASING.dwg