

EXCEPT WITH RESPECT TO THE OBLIGATIONS OF LANDLORD WHICH ARE EXPRESSLY PROVIDED IN THE LEASE, LANDLORD HAS MADE NO AGREEMENT, REPRESENTATION OR WARRANTY WITH RESPECT TO THE STATUS OR EXISTENCE OF ANY LEASE, OCCUPANCY OR USAGE OF ANY SPACE, OR THE EXISTENCE, DESIGN OR LOCATION OF ANY BUILDINGS, IMPROVEMENTS, PARKING AREAS, CURB CUTS, DRIVES OR OTHER COMMON AREAS WITH RESPECT TO THE SHOPPING CENTER OR ANY OUTPARCELS OR OTHER PROPERTY. LANDLORD BELIEVES THAT THE INFORMATION CONTAINED WITHIN THIS DRAWING IS PRESENTLY CORRECT, BUT LANDLORD MAKES NO WARRANTY, REPRESENTATION OR GUARANTEE AS TO ITS ACCURACY OR WHETHER IT WILL REMAIN AS CONFIGURED, AND LANDLORD RECOMMENDS THAT ALL INFORMATION BE FIELD VERIFIED PRIOR TO DESIGN AND CONSTRUCTION.

20 BROAD STREET, SUITE E
ELECTRICAL SERVICE: 100 AMP 480V 3 PHASE
W/ TRANSFORMER FOR 150 AMP 120/ 208V 3 PHASE
HVAC: (1) 5 TON = 5 TONS TOTAL
WATER HEATER: 40 GALLON GAS
RESTROOMS: NOT 2010 ADA COMPLIANT

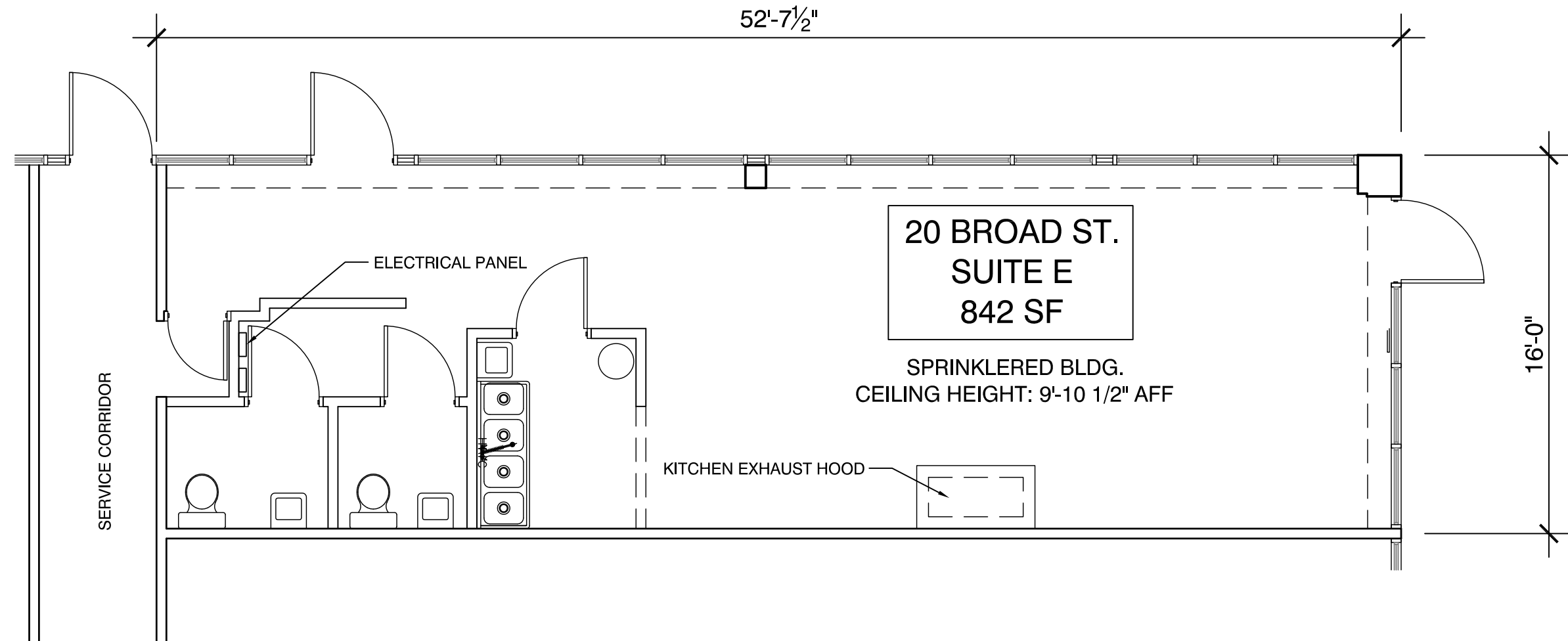

FIVE POINTS PLAZA - 20 BROAD STREET - SUITE E FLOOR PLAN

SCALE: 3/16"=1'-0"

20 BROAD STREET, SUITE E
ATLANTA, GEORGIA 30303

DRAWN BY: CO/KA
DATE: 06/13/17

1100 SPRING STREET NW SUITE 550
ATLANTA, GEORGIA 30309-2848
TEL (404) 876-5511 FAX (404) 875-2629

USER: jacker - Jun 13, 2017 - 5:07pm
S:\CONSTRUCTION\Auc\Auc\Ae_Built Drawings\Metal\Five Points Plaza\LOD\Five Points 20 E.rvt