



67 PEACHTREE PARK DRIVE

ATLANTA, GA 30309

SUITE 200
7,162 SF

Located in the fashionable Buckhead area, this building is accessible to the Peachtree Street corridor and is convenient to Atlanta's finest shops, restaurants, hotels and residential areas.

TOTAL SF	ZONING	ACCESSIBILITY	AVAILABLE
7,162	C2	BY APPT.	NOW

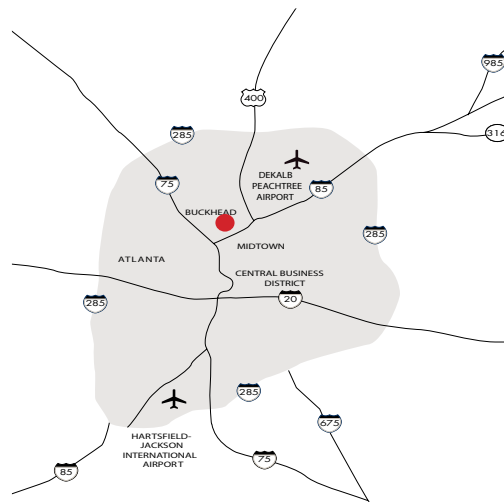

**EXCLUSIVELY
MARKETED BY:**

Jim Saine
(404) 898 9010
jsaine@seligenterprises.com



All measures, facts, and figures are subject to verification.

EXCEPT WITH RESPECT TO THE OBLIGATIONS OF LANDLORD WHICH ARE EXPRESSLY PROVIDED IN THE LEASE, LANDLORD HAS MADE NO AGREEMENT, REPRESENTATION OR WARRANTY WITH RESPECT TO THE STATUS OR EXISTENCE OF ANY LEASE, OCCUPANCY OR USE OF ANY SPACE, OR THE EXISTENCE, SIZE OR LOCATION OF ANY BUILDINGS, IMPROVEMENTS, PARKING AREAS, CURB CUTS, STREETS OR OTHER COMMON AREAS WITH RESPECT TO THE SHOPPING CENTER OR ANY OUTPARCELS OR OTHER PROPERTY. LANDLORD BELIEVES THAT THE INFORMATION CONTAINED WITHIN THIS DRAWING IS PRESENTLY CORRECT, BUT LANDLORD MAKES NO WARRANTY, REPRESENTATION OR GUARANTEE AS TO ITS ACCURACY OR WHETHER IT WILL REMAIN AS CONFIGURED, AND LANDLORD RECOMMENDS THAT ALL INFORMATION BE FIELD VERIFIED PRIOR TO DESIGN AND CONSTRUCTION.

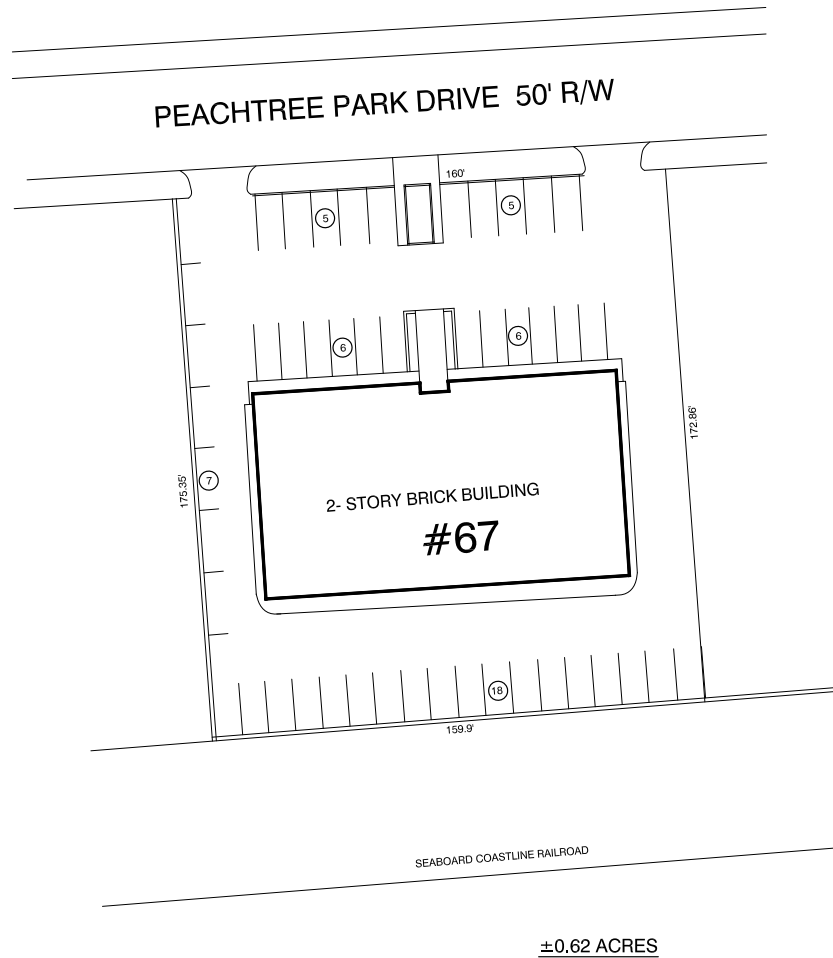

PEACHTREE PARK DRIVE: SITE PLAN

67 PEACHTREE PARK DRIVE
ATLANTA, GA. 30309

SCALE: 1"=40'

DATE: 6/10/14

DRAWN BY: D. ROBISON



1100 SPRING STREET NW SUITE 550
ATLANTA, GEORGIA 30309-2848
TEL (404) 876-5511 FAX (404) 875-2629

67 PEACHTREE PARK

ATLANTA, GA 30303



67 PEACHTREE PARK DR.

ATLANTA, GA 30309

