



455 EAST PACES FERRY

ATLANTA, GA 30305

SUITE 310

1,015 SF

Conveniently located in Buckhead, 455 East Paces Ferry Road offers excellent access to East Paces Ferry Road and Pharr Road, as well as I-85 and GA-400. Smaller spaces are available with ample free parking. Located next to the Suzuki Preparatory School.

TOTAL SF	ZONING	ACCESSIBILITY	AVAILABLE
1,015	SPI-9 SA3	BY APPT.	NOW

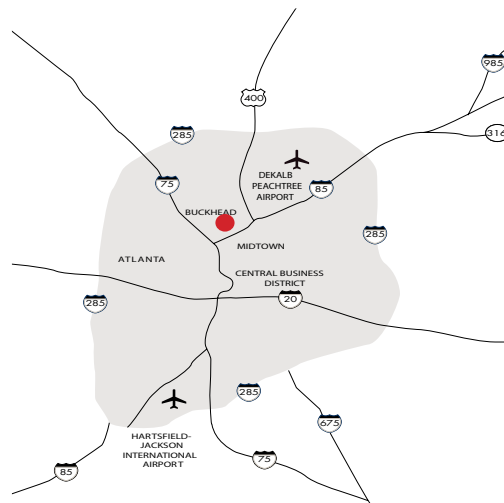

EXCLUSIVELY
MARKETED BY:

Jim Saine

(404) 898 9010

jsaine@seligenterprises.com



All measures, facts, and figures are subject to verification.

EXCEPT WITH RESPECT TO THE OBLIGATIONS OF LANDLORD WHICH ARE EXPRESSLY PROVIDED IN THE LEASE, LANDLORD HAS MADE NO AGREEMENT, REPRESENTATION OR WARRANTY WITH RESPECT TO THE STATUS OR EXISTENCE OF ANY LEASE, OCCUPANCY OR USAGE OF ANY SPACE, OR THE EXISTENCE, LOCATION OR LOCATION OF ANY BUILDINGS, IMPROVEMENTS, PARKING AREAS, CURBSIDES, DRIVEWAYS OR OTHER COMMON AREAS WITH RESPECT TO THE SHOPPING CENTER OR ANY OUTPARCELS OR OTHER PROPERTY. LANDLORD BELIEVES THAT THE INFORMATION CONTAINED WITHIN THESE DRAWINGS IS PRESENTLY CORRECT, BUT LANDLORD MAKES NO WARRANTY, REPRESENTATION OR GUARANTEE AS TO ITS ACCURACY OR WHETHER IT WILL REMAIN AS CONFIGURED, AND LANDLORD RECOMMENDS THAT ALL INFORMATION BE RECHECKED PRIOR TO DESIGN AND CONSTRUCTION.

30,230 SF TOTAL
100 PARKING SPACES
PARKING RATIO: 3.31 SP/1,000 SF

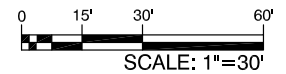
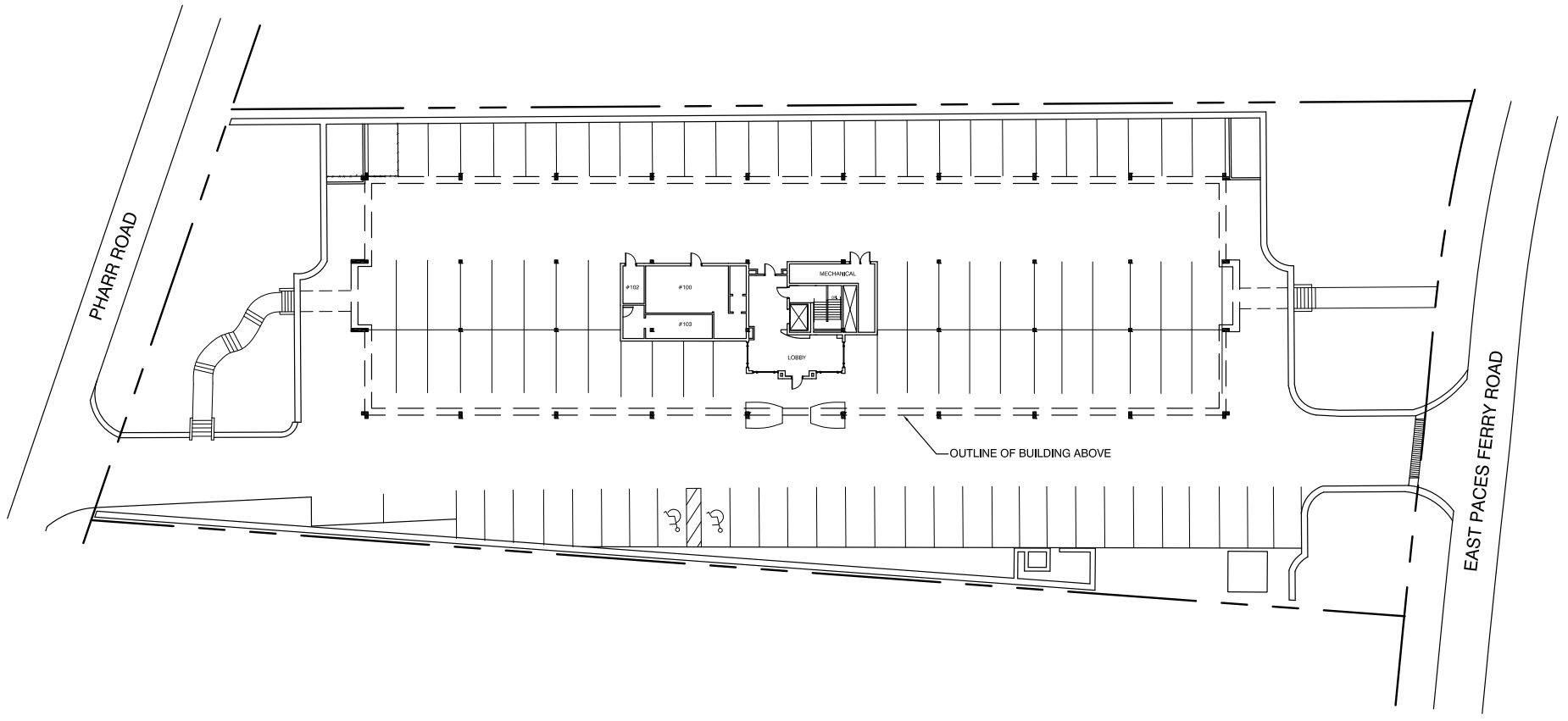

PACES CENTER - SITE PLAN
455 EAST PACES FERRY ROAD
ATLANTA, GA 30305

DRAWN BY: KA



1100 SPRING STREET NW SUITE 550
ATLANTA, GEORGIA 30309-2848
TEL (404) 876-5511 FAX (404) 875-2629

PHARR ROAD
EAST PACES FERRY ROAD

EXCEPT WITH RESPECT TO THE OBLIGATIONS OF LANDLORD WHICH ARE EXPRESSLY PROVIDED IN THE LEASE, LANDLORD HAS MADE NO AGREEMENT, REPRESENTATION OR WARRANTY WITH RESPECT TO THE STATUS OR EXISTENCE OF ANY LEASE, OCCUPANCY OR USAGE OF ANY SPACE, OR THE EXISTENCE, DESIGN OR LOCATION OF ANY BUILDINGS, IMPROVEMENTS, PARKING AREAS, CURB CUTS, DRIVES OR OTHER COMMON AREAS WITH RESPECT TO THE SHOPPING CENTER OR ANY OUTLINGS OR OTHER PROPERTY. LANDLORD BELIEVES THAT THE INFORMATION CONTAINED WITHIN THIS DRAWING IS PRESENTLY CORRECT, BUT LANDLORD MAKES NO WARRANTY, REPRESENTATION OR GUARANTEE AS TO ITS ACCURACY OR WHETHER IT WILL REMAIN AS CONFIGURED, AND LANDLORD RECOMMENDS THAT ALL INFORMATION BE FIELD VERIFIED PRIOR TO DESIGN AND CONSTRUCTION.

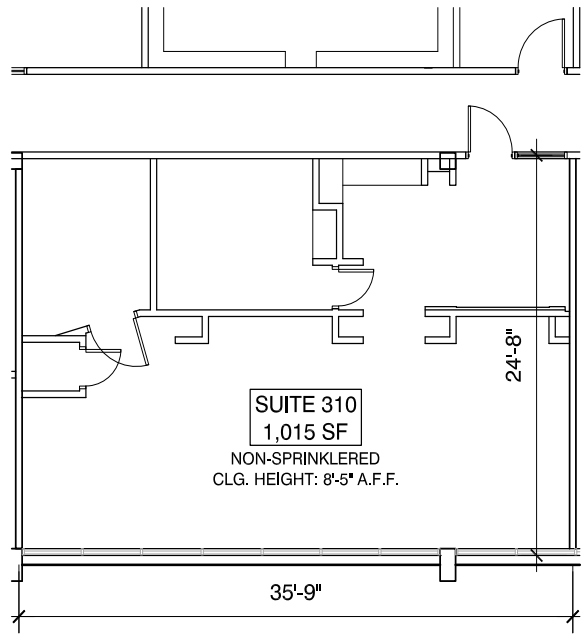

PACES CENTER: SUITE 310 - FLOOR PLAN

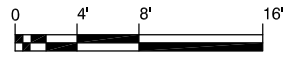

DRAWN BY: KA DATE: 02/24/20

455 EAST PACES FERRY ROAD, SUITE 310
ATLANTA, GEORGIA 30305



1100 SPRING STREET NW SUITE 550
ATLANTA, GEORGIA 30309-2846
TEL (404) 876-5511 FAX (404) 875-2829

USB: \\\servername\Fig 24_2020-2-26\Fig 24_2020-2-26\Drawings\PACECENTER\310\310.dwg User: ka Date: 2/24/20

455 EAST PACES FERRY

ATLANTA, GA 30305

