

TENANT LIST

SUITE 3158 A	--- THE MATTRESS FIRM	----- 4,650 SF
SUITE 3158 B	--- (AVAILABLE)	----- 2,055 SF
SUITE 3164	--- GINGER HOWARD SELECTIONS	----- 1,300 SF
SUITE 3166	--- BEVERLY BREMER'S SILVER SHOP	----- 2,904 SF
SUITE 3168	--- UNIGLOBE FIVE STAR TRAVEL	----- 1,300 SF
SUITE 3170	--- SWISS WATCH GALLERY	----- 1,476 SF
SUITE 3172	--- WHITE HOUSE RESTAURANT	----- 2,088 SF
SUITE 3174	--- BRAZILIAN WAX	----- 1,710 SF
SUITE 3176	--- PIZZA HUT	----- 1,122 SF

EXCEPT WITH RESPECT TO THE OBLIGATIONS OF LANDLORD WHICH ARE EXPRESSLY PROVIDED IN THE LEASE, LANDLORD HAS MADE NO AGREEMENT, REPRESENTATION OR WARRANTY WITH RESPECT TO THE STATUS OR EXISTENCE OF ANY LEASE, OCCUPANCY OR USAGE OF ANY SPACE, OR THE EXISTENCE, DESIGN OR LOCATION OF ANY BUILDINGS, IMPROVEMENTS, PARKING AREAS, CURB CUTS, DRIVES OR OTHER COMMON AREAS WITH RESPECT TO THE SHOPPING CENTER OR ANY OUTPARCELS OR OTHER PROPERTY. LANDLORD BELIEVES THAT THE INFORMATION CONTAINED WITHIN THIS DRAWING IS PRESENTLY CORRECT, BUT LANDLORD MAKES NO WARRANTY, REPRESENTATION OR GUARANTEE AS TO ITS ACCURACY OR WHETHER IT WILL REMAIN AS CONFIGURED, AND LANDLORD RECOMMENDS THAT ALL INFORMATION BE FIELD VERIFIED PRIOR TO DESIGN AND CONSTRUCTION.

18,605 SF TOTAL
62 PARKING SPACES
PARKING RATIO: 3.33 SP/1,000 SF

1.1573 ACRES

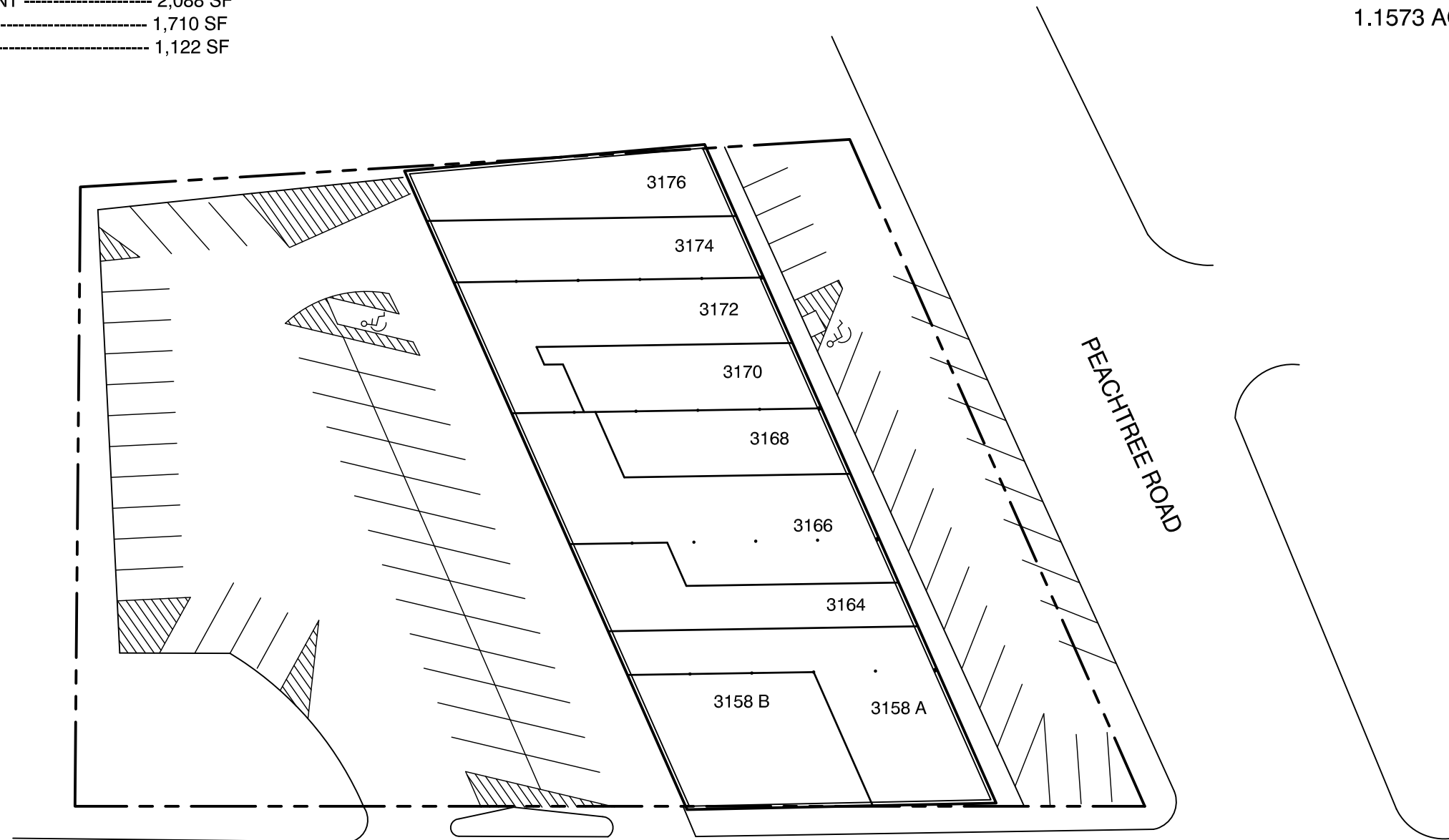

MATHIESON DRIVE

PEACHTREE ROAD



PEACHTREE PLAZA: LEASING PLAN

3158-3176 PEACHTREE ROAD
 ATLANTA, GA.

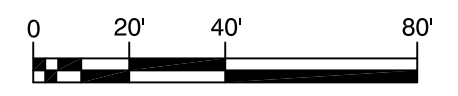

SCALE: 1"=40'

DRAWN BY: CO DATE: 05/01/14

1100 SPRING STREET NW SUITE 550
 ATLANTA, GEORGIA 30309-2848
 TEL (404) 876-5511 FAX (404) 875-2629

USER: conall - May 01, 2014 - 2:29pm
 S:\CONSTRUCTION\AutoCAD\As_Built Drawings\Retail\Peachtree Plaza\Site Plan\PEACHTREE PLAZA_LEASING.dwg