



BROOKWOOD PLACE

1745 Peachtree Street NE

Atlanta, Georgia 30309

Peachtree Street at 25th

LOWER LEVEL PARKING DECK- NORTH

LOWER LEVEL PARKING DECK- SOUTH

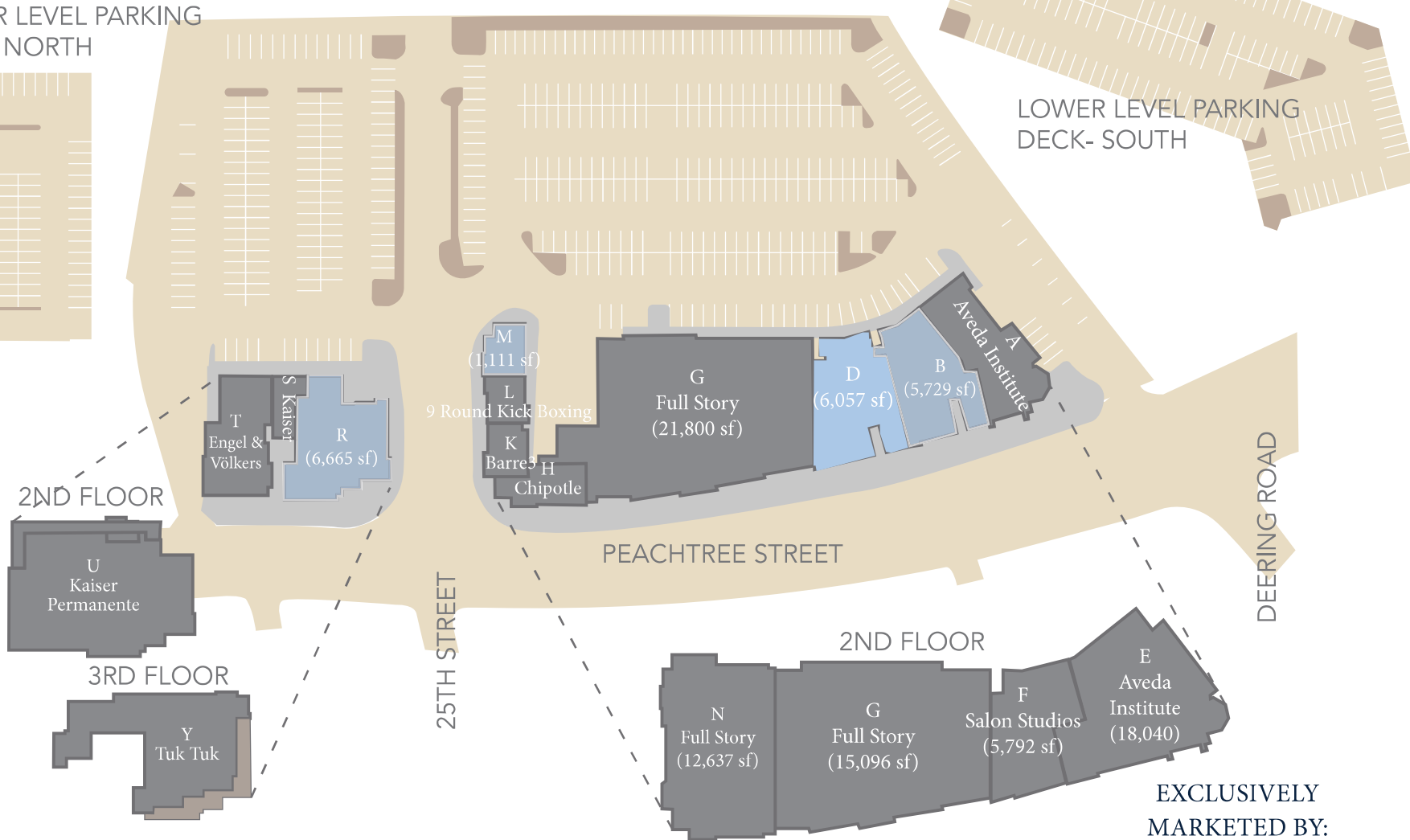

Available

ZONING: PD-MU
625 Parking Spaces
PARKING RATIO: 4.92 SP/ 1,000 SF

EXCLUSIVELY
 MARKETING BY:
 Shirley A. Gouffon
 (404) 898 9012
 sgouffon@seligenterprises.com