

TENANT LIST

SUITE A	--- CHINA GARDEN	----- 975 SF
SUITE B	--- H&R BLOCK	----- 975 SF
SUITE C	--- BUBBLES	----- 975 SF
SUITE D	--- CLEANERS	----- 1,300 SF
SUITE E	--- CREME DE LA CREME	----- 1,300 SF
SUITE F	--- THE UPS STORE	----- 975 SF
SUITE G	--- T-MOBILE	----- 1,950 SF

EXCEPT WITH RESPECT TO THE OBLIGATIONS OF LANDLORD WHICH ARE EXPRESSLY PROVIDED IN THE LEASE, LANDLORD HAS MADE NO AGREEMENT, REPRESENTATION OR WARRANTY WITH RESPECT TO THE STATUS OR EXISTENCE OF ANY LEASE, OCCUPANCY OR USAGE OF ANY SPACE, OR THE EXISTENCE, DESIGN OR LOCATION OF ANY BUILDINGS, IMPROVEMENTS, PARKING AREAS, CURB CUTS, DRIVES OR OTHER COMMON AREAS WITH RESPECT TO THE SHOPPING CENTER OR ANY OUTPARCELS OR OTHER PROPERTY. LANDLORD BELIEVES THAT THE INFORMATION CONTAINED WITHIN THIS DRAWING IS PRESENTLY CORRECT, BUT LANDLORD MAKES NO WARRANTY, REPRESENTATION OR GUARANTEE AS TO ITS ACCURACY OR WHETHER IT WILL REMAIN AS CONFIGURED, AND LANDLORD RECOMMENDS THAT ALL INFORMATION BE FIELD VERIFIED PRIOR TO DESIGN AND CONSTRUCTION.

8,450 SF TOTAL
33 PARKING SPACES
PARKING RATIO: 3.91 SP/1,000 SF

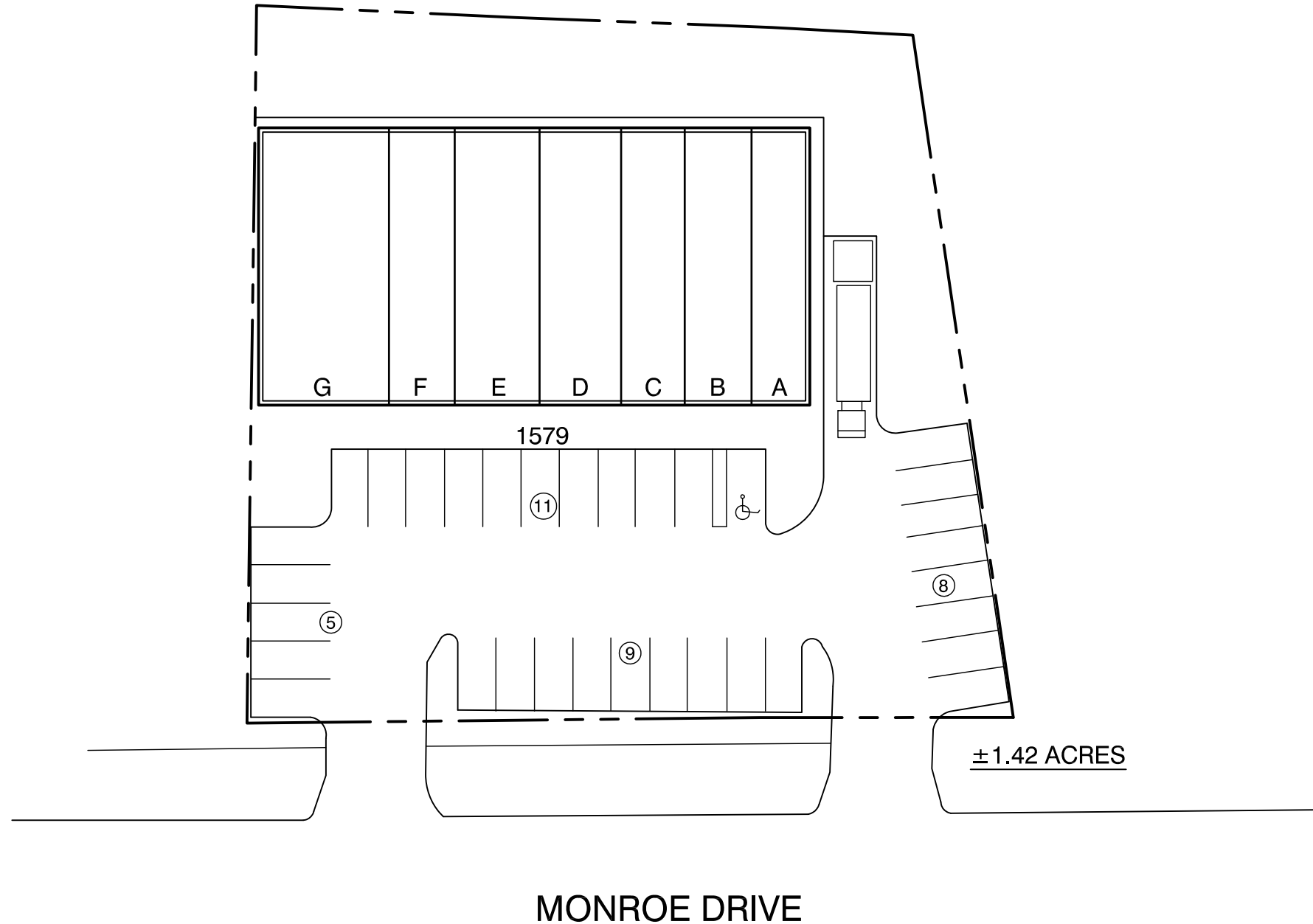

ANSLEY II: LEASING PLAN

1579 MONROE DR.
 ATLANTA, GA. 30324

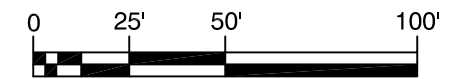

SCALE: 1"=50'

DRAWN BY: CO DATE: 07/10/14



1100 SPRING STREET NW SUITE 550
 ATLANTA, GEORGIA 30309-2848
 TEL (404) 876-5511 FAX (404) 875-2629

USER: conall - Jul 10, 2014 - 1:23:10pm
 S:\CONSTRUCTION\AutoCAD\As_Built Drawings\Retail\Anasley 2\Site Plan\ANSLEY_2_LEASING.dwg