

EXCEPT WITH RESPECT TO THE OBLIGATIONS OF LANDLORD WHICH ARE EXPRESSLY PROVIDED IN THE LEASE, LANDLORD HAS MADE NO AGREEMENT, REPRESENTATION OR WARRANTY WITH RESPECT TO THE STATUS OR EXISTENCE OF ANY LEASE, OCCUPANCY OR USAGE OF ANY SPACE, OR THE EXISTENCE, DESIGN OR LOCATION OF ANY BUILDINGS, IMPROVEMENTS, PARKING AREAS, CURB CUTS, DRIVES OR OTHER COMMON AREAS WITH RESPECT TO THE SHOPPING CENTER OR ANY OUTPARCELS OR OTHER PROPERTY. LANDLORD BELIEVES THAT THE INFORMATION CONTAINED WITHIN THIS DRAWING IS PRESENTLY CORRECT, BUT LANDLORD MAKES NO WARRANTY, REPRESENTATION OR GUARANTEE AS TO ITS ACCURACY OR WHETHER IT WILL REMAIN AS CONFIGURED, AND LANDLORD RECOMMENDS THAT ALL INFORMATION BE FIELD VERIFIED PRIOR TO DESIGN AND CONSTRUCTION.

ELECTRICAL SERVICE: (2) 100 AMP 240 VOLT
 3 PHASE 4 WIRE
 HVAC: (2) 5 TONS
 PARKING RATIO: 3.79 SPACES PER 1,000 SF

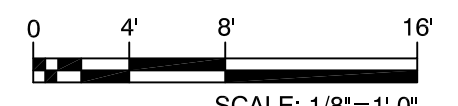
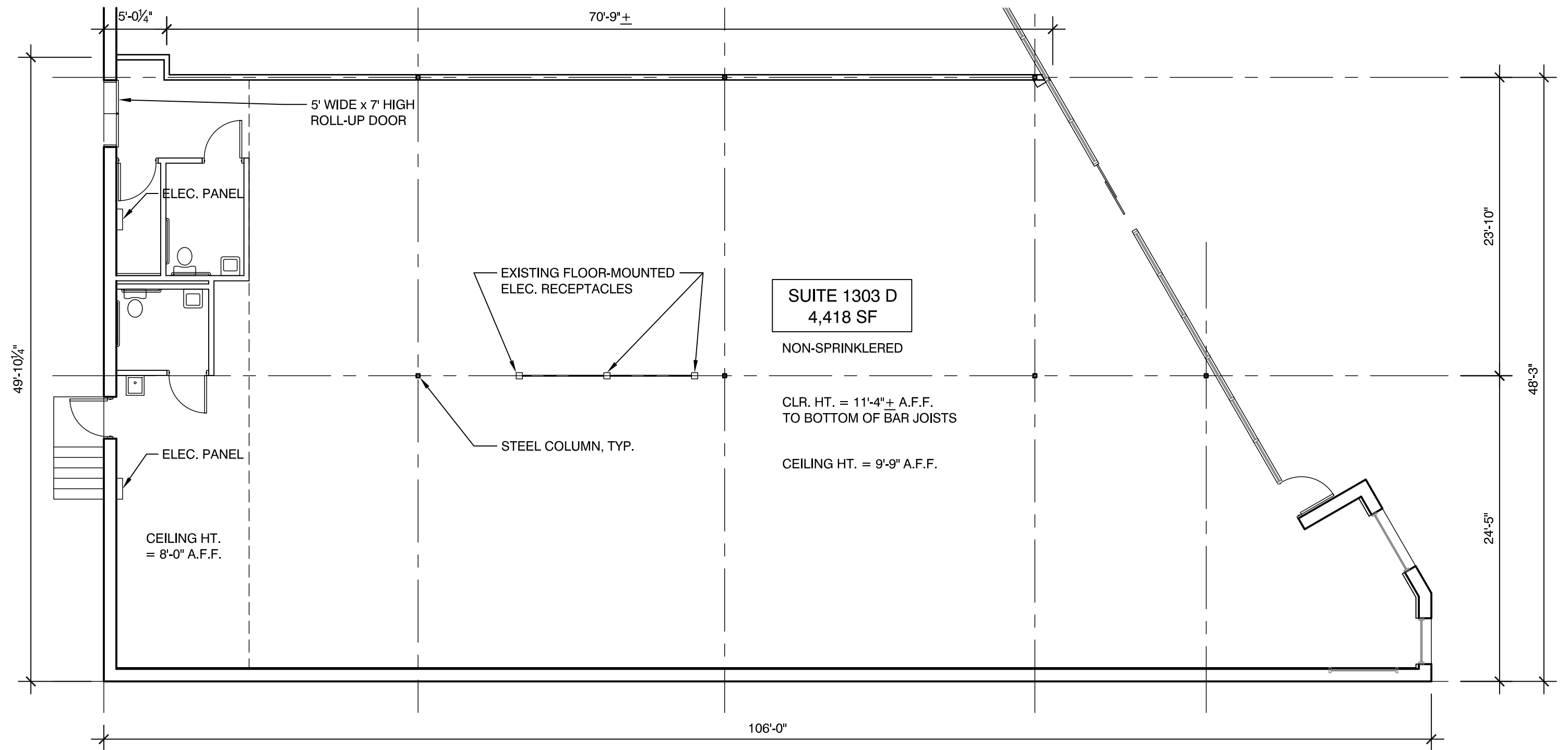

AVONDALE CROSSING: SUITE 1303 D - FLOOR PLAN

1303 COLUMBIA DRIVE
 DECATUR, GA. 30032

DRAWN BY: CO DATE: 05/14/13

SELIG
 ENTERPRISES, INC.

1100 SPRING STREET NW SUITE 550
 ATLANTA, GEORGIA 30309-2848
 TEL (404) 876-5511 FAX (404) 875-2629

USER: c:\email - Dec 12, 2016 - 11:48am
 S:\CONSTRUCTION\Avondale Crossing\Retail\Avondale Crossing\1303 D-E.dwg