



5158 KENNEDY ROAD

FOREST PARK, GA 30297

SUITE E
14,826 SF

Conveniently located in Northeast Atlanta, these spaces offer excellent access to I-85 and I-285 as well as great street front visibility. Spaces range from 3,386 SF to 6,654 SF and are well-suited for showroom or office use.

EXCLUSIVELY
MARKETED BY:

Kent Walker
(404) 898 9032

kwalker@seligenterprises.com



All measures, facts, and figures are subject to verification.

TOTAL SF	OFFICE SF	CLEAR HEIGHT	DOCK DOORS	ZONING	SPRINKLER	ELECTRICAL	ACCESSIBILITY	AVAILALBLE
14,826	2,157	20'2"	4 dh	O-I	YES	200a/240v/3ph	By Appt	5/21

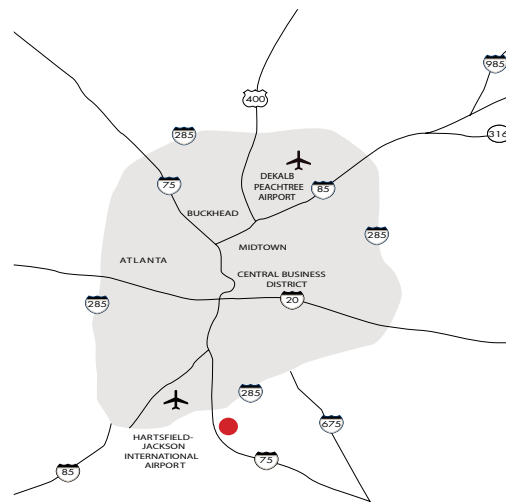

EXCEPT WITH RESPECT TO THE OBLIGATIONS OF LANDLORD WHICH ARE EXPRESSLY PROVIDED IN THE LEASE, LANDLORD HAS MADE NO AGREEMENT, REPRESENTATION OR WARRANTY WITH RESPECT TO THE STATUS OR EXISTENCE OF ANY LEASE, OCCUPANCY OR USAGE OF ANY SPACE, OR THE EXISTENCE, DESIGN OR LOCATION OF ANY BUILDINGS, IMPROVEMENTS, PARKING AREAS, DRIVE SUIES, DRIVES OR OTHER COMMON AREAS WITH RESPECT TO THE SHOPPING CENTER OR ANY OUTPARCELS OR OTHER PROPERTY. LANDLORD BELIEVES THAT THE INFORMATION CONTAINED WITHIN THIS DRAWING IS PRESENTLY CORRECT, BUT LANDLORD MAKES NO WARRANTY, REPRESENTATION OR GUARANTEE AS TO ITS ACCURACY OR WHETHER IT WILL REMAIN AS CONFIGURED, AND LANDLORD RECOMMENDS THAT ALL INFORMATION BE FIELD VERIFIED PRIOR TO DESIGN AND CONSTRUCTION.

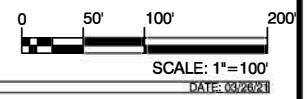
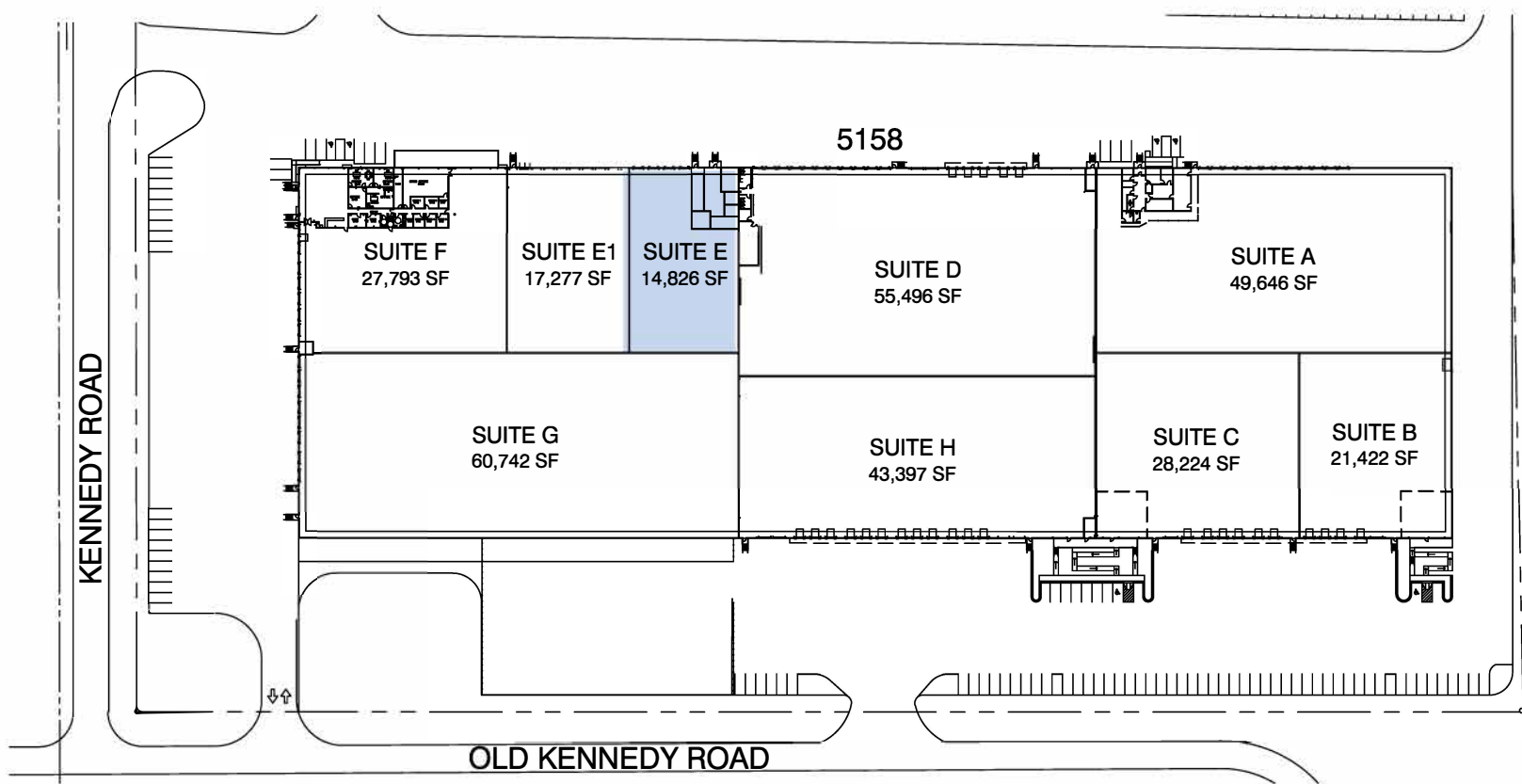

DRAWN BY: CO/KA

SELIG
ENTERPRISES, INC.

1100 SPRING STREET NW SUITE 550
ATLANTA, GEORGIA 30309-2848
TEL. (404) 876-5511 FAX (404) 875-2629

5158 KENNEDY ROAD: LEASING PLAN

5158 KENNEDY ROAD
FOREST PARK, GEORGIA 30297



1/20/21 1:45pm - New 02/19/21 - 1:47:11 PM
E:\CONSTRUCTION\5158 Kennedy Road\5158 Kennedy Road\5158 Kennedy Road.dwg (Drawing) Layout 03/11/21.swg

EXCEPT WITH RESPECT TO THE OBLIGATIONS OF LANDLORD WHICH ARE EXPRESSLY PROVIDED IN THE LEASE, LANDLORD HAS MADE NO AGREEMENT, REPRESENTATION OR WARRANTY WITH RESPECT TO THE STATUS OR EXISTENCE OF ANY LEASE, OCCUPANCY OR USAGE OF ANY SPACE, OR THE EXISTENCE, DESIGN OR LOCATION OF ANY BUILDINGS, IMPROVEMENTS, PARKING AREAS, CURB CUTS, DRIVES OR OTHER COMMON AREAS WITH RESPECT TO THE SHOPPING CENTER OR ANY OUTPARCELS OR OTHER PROPERTY. LANDLORD BELIEVES THAT THE INFORMATION CONTAINED WITHIN THIS DRAWING IS PRESENTLY CORRECT, BUT LANDLORD MAKES NO WARRANTY, REPRESENTATION OR GUARANTEE AS TO ITS ACCURACY OR WHETHER IT WILL REMAIN AS CONFIGURED, AND LANDLORD RECOMMENDS THAT ALL INFORMATION BE FIELD VERIFIED PRIOR TO DESIGN AND CONSTRUCTION.

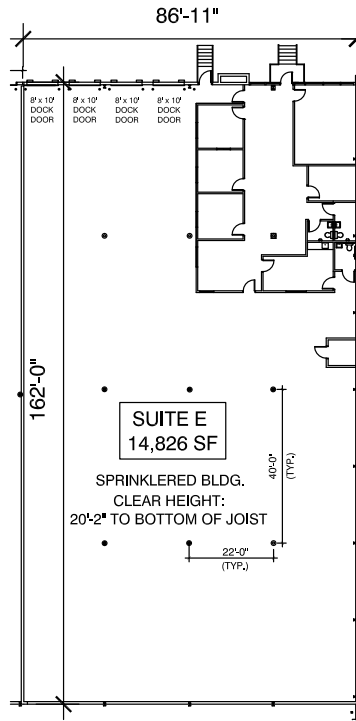

5158 KENNEDY ROAD, SUITE E - FLOOR PLAN

5158 KENNEDY ROAD, SUITE E
FOREST PARK, GEORGIA 30297

DRAWN BY: KA DATE: 03/09/21

1100 SPRING STREET NW SUITE 550
ATLANTA, GEORGIA 30309-2848
TEL (404) 876-5511 FAX (404) 875-2629

USER: kaker - Mar 24, 2021 - 2:59PM
 S:\CONTRACTS\2020\5158KENNEDY\Bldg Design\plan\miflorney\5158E\0305158 Kennedy Floor E.dwg

5158 KENNEDY ROAD

FOREST PARK, GA 30297

