

The information depicted by, described or contained in this document is preliminary and subject to change without notice.

THIS DRAWING IS THE PROPERTY OF RULE JOY TRAMMELL + RUBIO, LLC AND MAY NOT BE REPRODUCED WITHOUT WRITTEN CONSENT. © 2008

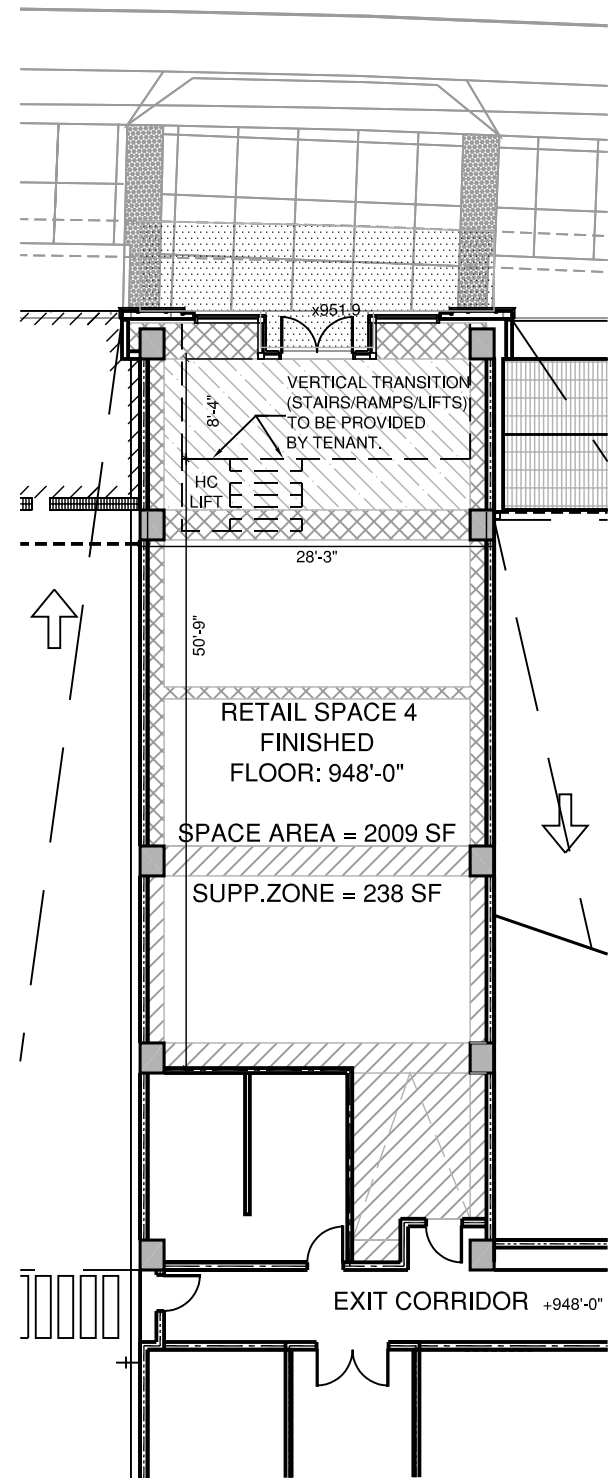

| LEGEND | |
|--|---|
| | SUPPLEMENTAL ZONE |
| | STRUCTURE ABOVE: 17'-0" (16'-7" CLEAR) |
| | STRUCTURE ABOVE: 17'-0" (15'-3" CLEAR) |
| | VARIES FROM 13'-3" TO 15'-3" (RAMP ABOVE) |
| | VARIES FROM 28'-0" TO 29'-3" (RAMP ABOVE) |
| AREA | = 2,009 SF |
| FINISH FLOOR | = 948'-0" |
| STRUCTURE ABOVE | = 963'-0" & 965'-0" |
| RETAIL PARKING DURING OFFICE BUSINESS HOURS = 163 SPACES (2.7/1000) | |
| RETAIL PARKING AFTER OFFICE BUSINESS HOURS = 1099 SPACES (18.3/1000) | |
| TOTAL RETAIL SF: +/- 60,000 SF | |
| RETAIL PATRON PARKING ON LEVELS 7 AND 9 | |
| SERVICE AND LOADING ON LEVEL 5 | |
| ACCESSIBILITY: TRANSITION REQUIRED | |

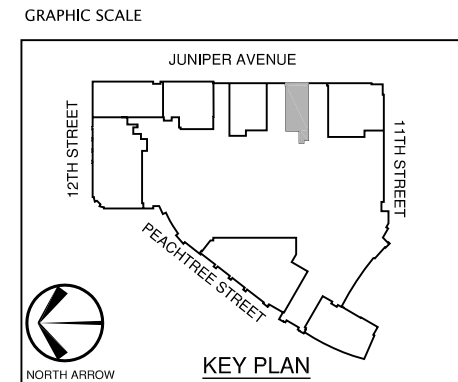
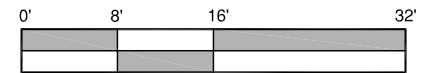

BASE BUILDING SHELL

JUNIPER STREET LEVEL 5

DATE:
SEPT. 18, 2009

SPACE NO.:
RETAIL SPACE
NO. 4

1075 PEACHTREE
Atlanta, Georgia



EXHIBIT "E"
PREMISES
LEASE OUTLINE DRAWING